

QuickClip Pro™ Clip Fixing Device (HX-202LR, HX-202UR) Quick Reference Guide

QuickClip Pro is designed for endoscopic clip placement within the gastrointestinal tract.

CAUTION: This guide is only a summary of the instructions for use for the HX-202LR and HX-202UR QuickClip Pro. Be sure to follow the Instruction Manual included in the device packaging.

Preparation before use

- 1 Remove the device from the package. Remove the black protective cap. Confirm the yellow tube joint, red stopper and handle are connected without any gaps, and insert the device into the endoscopic channel.



Once the device extends from the distal end of the endoscope, remove the red stopper.



Connect the yellow tube joint and the distal end of the handle.



The clip will automatically open as it extends from the sheath. If you prefer to have the clip exit in a closed position, apply slight pressure to the slider of the handle as the yellow tube joint and handle are connected.

Align the clip with the target site

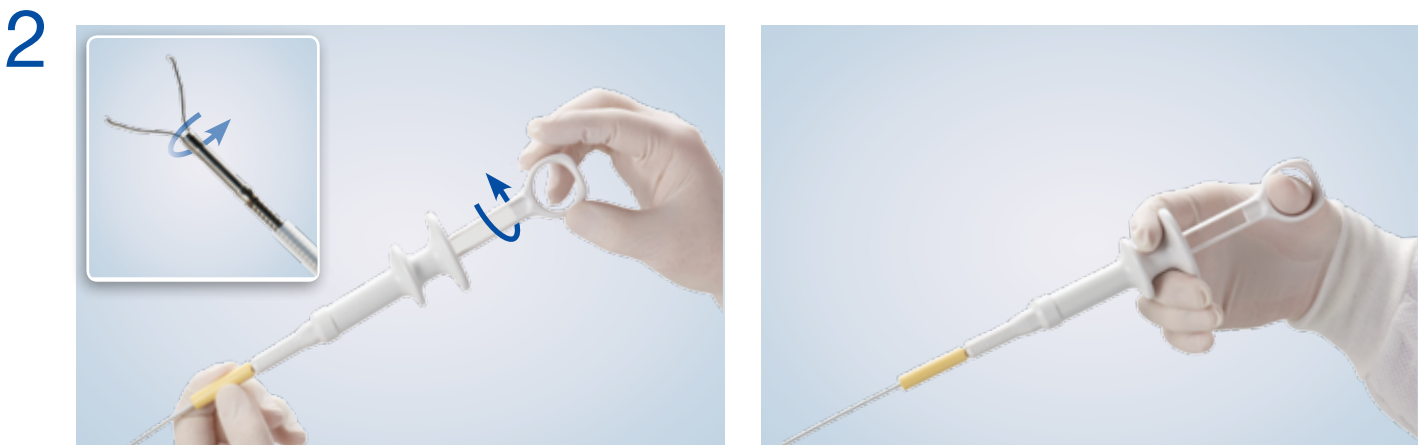

To align the clip with the target site, hold the yellow cylinder with one hand and rotate the entire handle with the other hand.

When the clip is in the desired position, remove your hand from the yellow stopper.

QuickClip Pro™ Clip Fixing Device (HX-202LR, HX-202UR)

Quick Reference Guide



QuickClip Pro is designed for endoscopic clip placement within the gastrointestinal tract.

CAUTION: This guide is only a summary of the instructions for use for the HX-202LR and HX-202UR QuickClip Pro. Be sure to follow the Instruction Manual included in the device packaging.

Operation and functionality

3

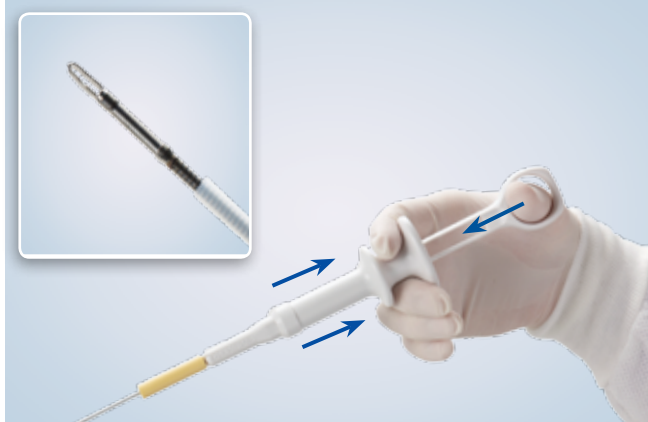

To close: Pull the slider toward the thumb ring until you feel resistance and see on the endoscopic view that the clip arms are closed.



To reopen: Push the slider away from the thumb ring to reposition the clip as needed before deployment.

Deploying the clip at the target site

4

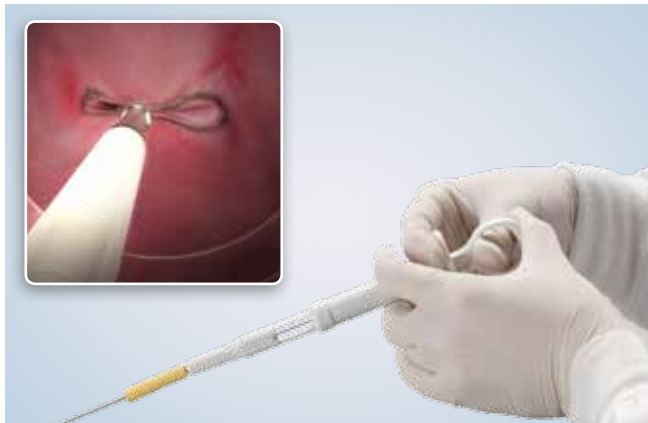

Press the clip firmly against the target tissue and close the clip. Deploy the clip by pulling the slider with both hands toward the thumb ring. You will feel pressure and hear a noticeable click.



Push the slider completely away from the thumb ring to release the clip. Visually confirm the clip has released prior to removing the sheath from the scope.

Olympus and QuickClip Pro are trademarks or registered trademarks of Olympus Corporation, Olympus America Inc., and/or their affiliates.

OLYMPUS

OLYMPUS AMERICA INC.
3500 Corporate Parkway, PO Box 610, Center Valley, PA 18034

For more information, contact your Olympus sales representative, or call 800-848-9024.
www.medical.olympusamerica.com

©2015 Olympus America Inc. All rights reserved.
Printed in the USA OAIET1015QRG17044