

InstaClear

Set-Up and Operation Quick Reference Guide



This Set-Up Guide is only a summary of the InstaClear *Instructions for Use* (IFU). For detailed operating instructions, be sure to follow the InstaClear IFU that was included with your device when purchased.

Set-Up and Operation

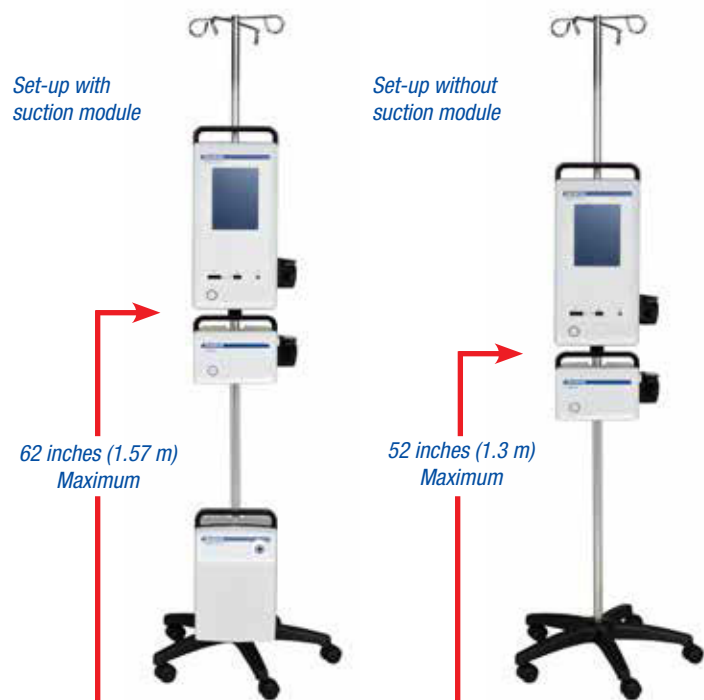

1 Set-Up: Ensure the console is properly assembled onto an IV pole before use. To reduce the risk of tipping and possible equipment damage, always follow the recommended height guidelines shown above.

2 The power cord needs to be attached to the back of the unit and to a grounded wall outlet. For best results, use a dedicated vacuum source such as the DIEGO® ELITE suction module. If using the DIEGO® ELITE suction module, insert the filter end of the suction tubing (TS102SF) into the suction connection on the front of the suction module. Attach the blue suction connector at the other end of the suction tubing to the suction canister.

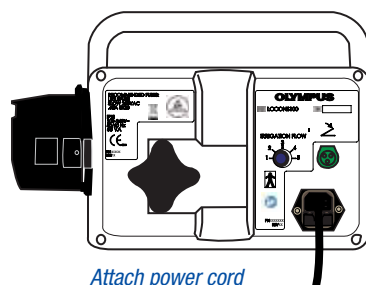

Attach power cord

3 Power ON: Turn the InstaClear system on by pressing the power button at the lower left corner on the front of the console. The power switch will illuminate.



Turn the Console ON

4 Connect Footpedal: Align the footpedal plug and footpedal socket (on the rear of the console) and insert the plug fully into the socket.



Connect Footpedal

5 Assemble Endoscope in Sheath: Grasp the sheath by the hub and slide it over the end of the scope, hub end first, until it stops at the distal end (a slight gap is appropriate between the sheath hub and the light post).

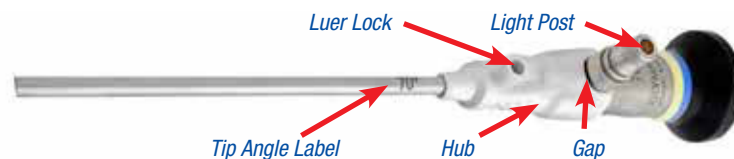

6 Attach Sheath to Tubeset: Thread the Luer lock connector of the tubeset onto the Luer lock port of the sheath.



7 Attach Irrigation: With the pump lever open, position the blue portion of the tubeset across the tube guide. Thread the clear portion of the tubeset through the pump and close the pump lever. Remove the IV spike cover and insert the IV spike into the IV bag.



8 Attach Suction: While pressing the button on the pinch valve, insert the blue tubing through the slot of the pinch valve and around the strain relief hook below. Release the button on the pinch valve. Connect the suction end of the tubeset to the vacuum canister.



Strain Relief Hook

9 Prime: Press and hold down the footpedal to perform the priming sequence. When fluid can be seen flowing out of the distal tip of the sheath, the priming sequence is complete.



Footpedal

10 Unhook the tubeset from the sheath. Slide the sheath distally off the endoscope to disassemble and dispose of the sheath. Press the pinch valve button on the InstaClear console and remove the blue tubing from the pinch valve. Open the pump lever and remove the tubing from the pump. Pull the IV spike from the IV bag, using care not to spill any remaining fluid, and dispose of the tubeset. Press the power button to turn off the system. Disconnect the power cord from the wall outlet. Clean and disinfect the console and footpedal according to the IFU.