

# Flexible Endoscope Cleaning & Disinfection Guide

CYF-V2

CYF-5

URF-V

URF-P5

HYF-XP

HYF-V\*

\* not available in some areas.

## Precleaning

### 1 Wipe the insertion tube



Gently wipe the external surfaces of the insertion tube with a cloth moistened in detergent solution.

### 2 Detach accessories



Disconnect the forceps/irrigation plug.

### 3 Flush detergent



Fill a syringe with detergent solution and flush the solution through the instrument channel three times.



- This guide is only a summary of the steps necessary to properly reprocess your endoscope. Follow the detailed steps outlined in the ENDOSCOPE REPROCESSING MANUAL that was included with your endoscope.
- Use detergent solution and disinfectant solution which feature validated processes in accordance with national and local regulations and/or guidelines.

## Leakage testing

### 4 Attach the tester



Attach the leakage tester to the venting connector on the endoscope.

### 5 Apply pressure



When using MB-155 with MU-1 or the light source



When using WA23070A or A2377

or

Connect MB-155 to the maintenance unit (MU-1) or the light source and turn the power switch on.

Close the pressure release lever. Press the hand pump so that the pointer stays within the green area.

### 6 Observe



Immerse the entire endoscope in water, observe for 30 seconds while angulating the bending section and confirm that there is no continuous series of bubbles.

**CAUTION:** If a leak is detected, remove from water and contact Olympus.

### 7 Detach the tester



Remove the endoscope from the water and release the air pressure in the endoscope.\*

\* When using WA23070A or A2377, open the pressure release lever.  
\* When using MB-155, turn the maintenance unit or light source off. Detach the leakage tester from the air source and then the endoscope.

## Manual Cleaning

### 8 Brush the channel



Immerse the endoscope in detergent solution. Clean the external surfaces using a clean cloth. Brush the instrument channel and channel port. Repeat until all debris is removed.

### 9 Clean the channel



Fill a syringe with detergent solution and flush the solution through the instrument channel three times.

### 10 Clean the surfaces



Using a lint-free cloth, gently wipe all debris from the endoscope's external surfaces, while the endoscope is immersed in detergent solution. Soak in detergent solution for the recommended time.

### 11 Rinse the endoscope



Immerse the endoscope in water and rinse. Attach a syringe and flush clean water through the channel three times. Remove the endoscope from water and inject air three times.

### 12 Wipe the surfaces



Using a lint-free cloth, thoroughly and gently wipe and dry the external surfaces of the endoscope in preparation for disinfection.

## Disinfection

### 13 Flush disinfectant



Immerse the endoscope in the disinfectant solution. Using a syringe, fill the channel with disinfectant solution.

### 14 Disinfect the endoscope



Disconnect the syringe while the endoscope is immersed. Soak for the time specified by the manufacturer.

## Rinsing

### 15 Rinse the surfaces



Remove the endoscope from the disinfectant solution and immerse in deionized water. Using a sterile, lint-free cloth, thoroughly rinse and gently wipe all external surfaces.

### 16 Rinse the channel



Attach a syringe and flush deionized water three times and inject air three times.

### 17 Flush alcohol and air



Attach a syringe filled with alcohol and flush three times. Inject air three times.

### 18 Wipe the surfaces



Disconnect the syringe. Using a sterile, lint-free cloth, thoroughly and gently wipe and dry the external surfaces of the endoscope.

### 19 Wipe the surfaces with alcohol



Using a sterile, lint-free cloth moistened with alcohol, thoroughly and gently wipe the external surfaces of the endoscope.

# Reprocessing Tools

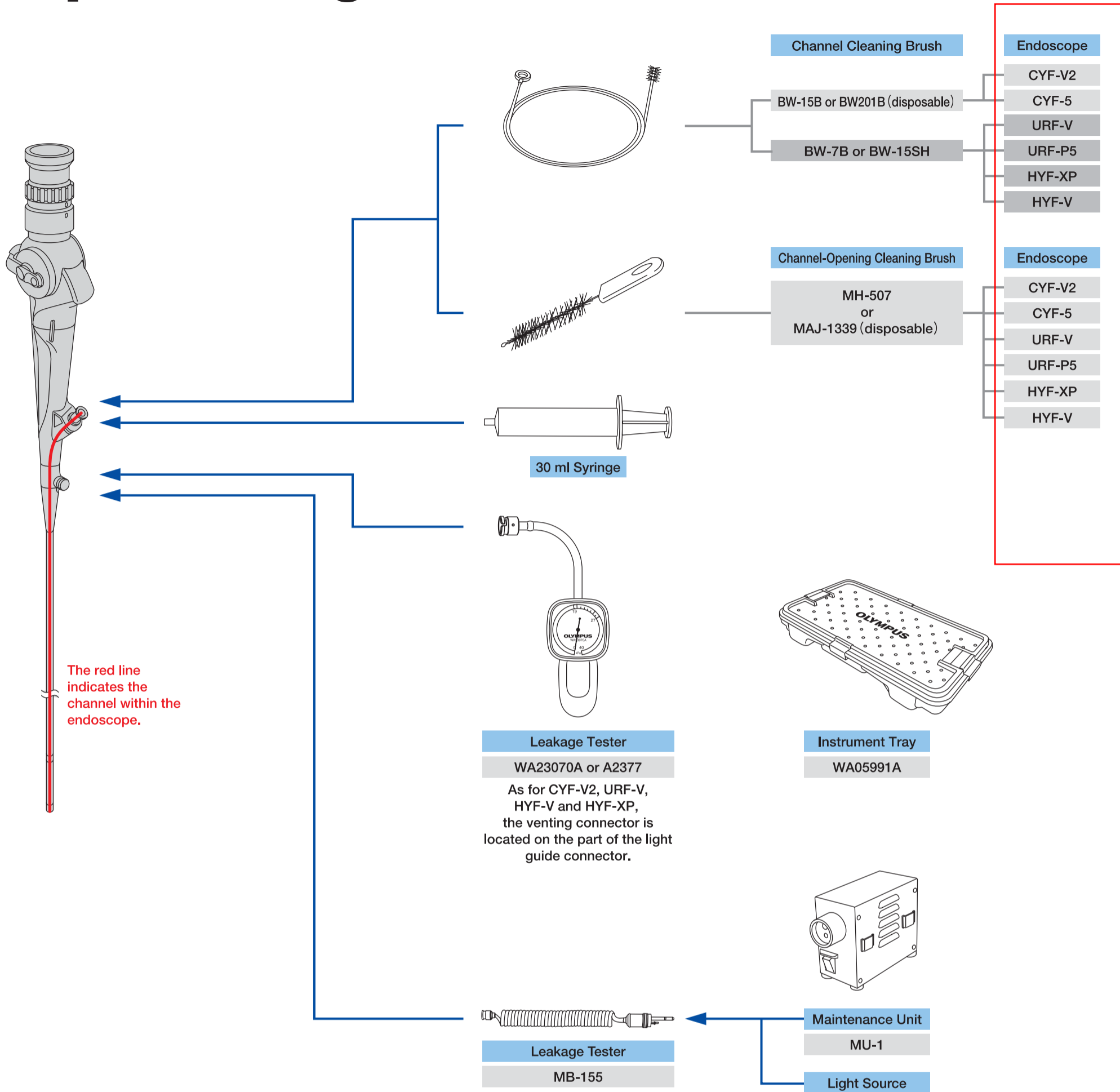

- Clean, disinfect, sterilize all attachments and cleaning accessories according to their instruction manual.
- Always wear personal protective equipment when cleaning, disinfecting, or sterilizing an endoscope.
- ALL channels of the endoscope MUST be cleaned and disinfected or sterilized during EVERY reprocessing cycle, even if the channels were not used during the previous patient procedure.
- Decisions regarding what methods of cleaning, disinfection, sterilization should be used are the responsibility of trained specialists.
- Contact your local hygiene representative to determine the situation in which disinfection rather than sterilization would be appropriate in your facility.
- When you use detergent solution and disinfectant solution, always follow the manufacturer's recommendations regarding temperature and soaking time.

**OLYMPUS**<sup>®</sup>

Your Vision, Our Future