

CELERIS™ System Set-up and Operation Quick Reference Guide

CAUTION: This guide is only a summary of the instructions for use for CELERIS Disposable Sinus Debrider. Be sure to follow the Olympus instruction manual that was included in the device package.

System Components



CELERIS System Set-up and Operation

- 1 Remove the Sinus Debrider and all components from the packaging using aseptic technique.



CELERIS™ System Set-up and Operation

Quick Reference Guide

CAUTION: This guide is only a summary of the instructions for use for CELERIS Disposable Sinus Debrider. Be sure to follow the Olympus instruction manual that was included in the device package.

CELERIS System Set-up and Operation (continued)

- 2** Plug the Sinus Debrider power cord into the CELERIS Reusable Power Pack and ensure that the **green light** is illuminated.

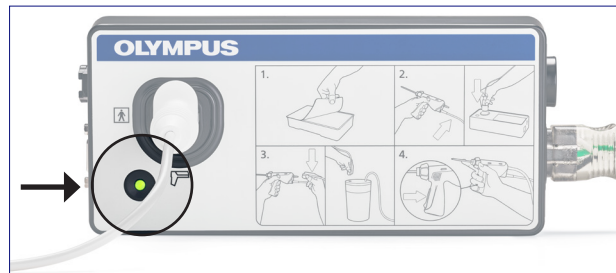

- 3** Connect the suction tubing to the suction port luer fitting on the back of the debrider.

(Optional) If using Diego Elite, Suction Module, connect suction module to the DB9 connector on the Power Pack.



- 4** Connect the Bipolar cord to the RF generator* (if applicable).

- 5** (Optional) Connect the InstaClear™ footswitch to the Power Pack if using a footswitch.



- 6** Press the cut trigger (or footswitch) to activate the Sinus Debrider.

*Inspect the cable and insulation prior to use. Insulation failure may result in burs or other injuries to the patient or user. Only make connections while the energy is off. Failure to do so may result in an injury or electrical shock to the patient or user. Refer to generator's instruction manual for detailed setup instructions.

Manufactured by Olympus Surgical Technologies America, 9600 Louisiana Ave. North Brooklyn Park, MN 55445. Olympus is a registered trademarks of Olympus Corporation, Olympus America Inc., and/or their affiliates. | Medical devices listed may not be available for sale in all countries.

OLYMPUS

OLYMPUS AMERICA INC.
3500 Corporate Parkway, PO BOX 610, Center Valley, PA 18034

For more information, contact your Olympus sales representative, or call 800-848-9024.
www.medical.olympusamerica.com

©2022 Olympus America Inc. All rights reserved.
Printed in USA OAIENT0422QRG43721