

How to use the distal-end flushing adapter

MAJ-2319 for EVIS EXERA III Duodenovideoscope TJF-Q190V

WARNING



This quick reference guide is a summary of the steps necessary to properly use your MAJ-2319. Follow the detailed steps instructed in the latest **REPROCESSING MANUAL** for TJF-Q190V

Attaching & detaching MAJ-2319 to the distal-end of the endoscope*

MAJ-2319

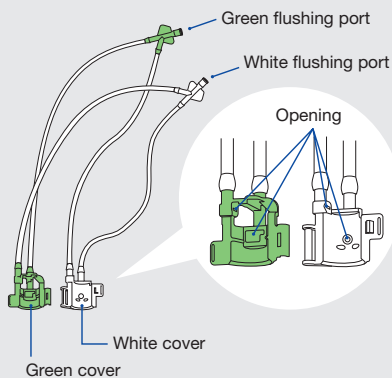

Attaching

1

The instrument channel outlet of the distal end is opened. (the elevator control lever is in the opposite direction of the "U" direction)

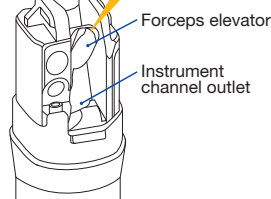

2

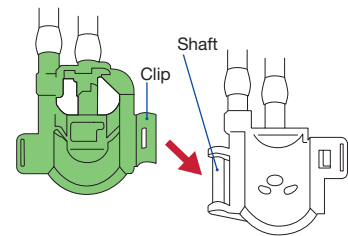

Hold the MAJ-2319. Then attach the clip of the green cover to the shaft of the white cover.

3

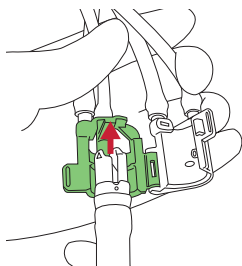

Put the distal-end of the endoscope inside the green cover with the back side surface viewable

4

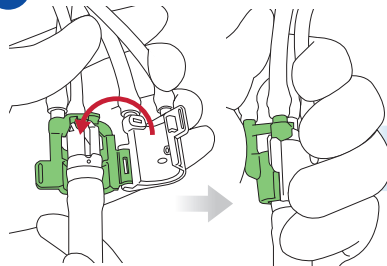

Shut the white cover and the green cover with a snap.

5

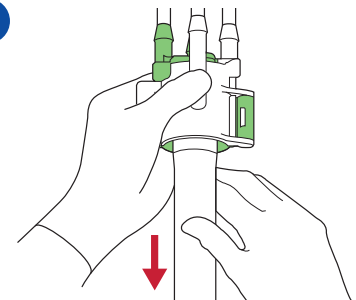

Gently pull the endoscope to ensure that the distal-end stays within the MAJ-2319 and does not come out.

Detaching

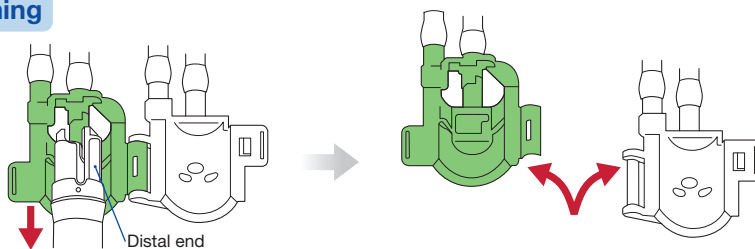

Open the white cover and the green cover to detach MAJ-2319 from the endoscope. Then separate the white cover and the green cover.

* All process to be managed with all instruments immersed in the appropriate liquid

Manually cleaning process with MAJ-2319

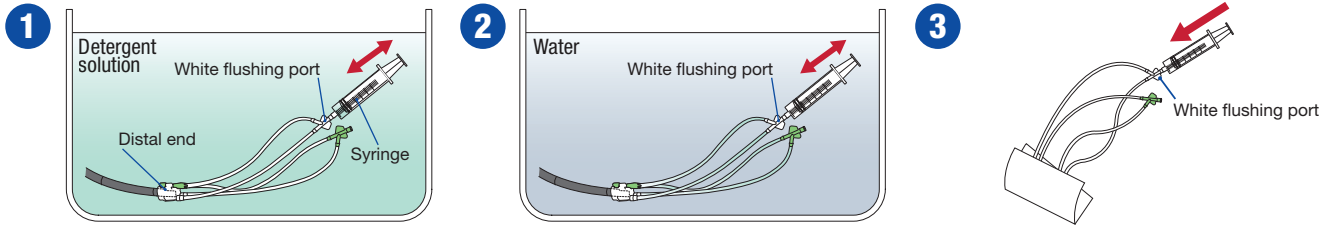



	Flush content	Total flush volume (from each port)	Procedure 
1	Detergent solution	180 ml	(Repeat the same procedure from the green flushing port in the all procedure)
2	Water	90 ml	
3	Air	30 ml	

While immersing a 30 ml syringe completely in the appropriate liquid, slowly fill it with the appropriate liquid, attach it to the white flushing port, and forcefully flush the distal-end with 30 ml of the liquid. Then with immersing the syringe attached to the port in the appropriate liquid completely, repeat pumping several times (until the volume reaches the specified number)

Cover the white cover and the green cover of MAJ-2319 in clean lint-free cloths to prevent splashing from the openings of the covers. Fill the syringe with air, attach it to the white flushing port, and flush the adapter with 30 ml of air.

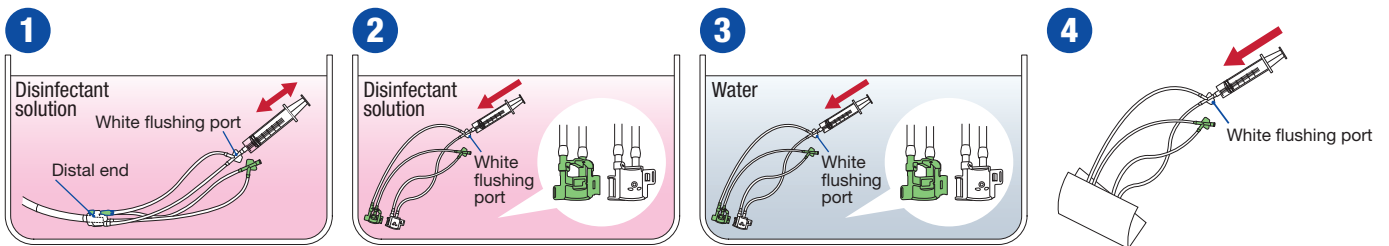
Manually disinfecting process with MAJ-2319





	Flush content	Total flush volume (from each port)	Procedure 
1	Disinfectant solution	180 ml	(Repeat the same procedure from the green flushing port in the all procedure)
2	Air	30 ml	
3	Water	30 ml	
4	Air	30 ml	

While immersing a 30 ml syringe completely in the appropriate liquid, slowly fill it with the appropriate liquid, attach it to the white flushing port, and forcefully flush the distal-end with 30 ml of the liquid. Then with immersing the syringe attached to the port in the appropriate liquid completely, repeat pumping several times (until the volume reaches the specified number)

Cover the white cover and the green cover of MAJ-2319 in clean lint-free cloths to prevent splashing from the openings of the covers. Fill the syringe with air, attach it to the white flushing port, and flush the adapter with 30 ml of air.

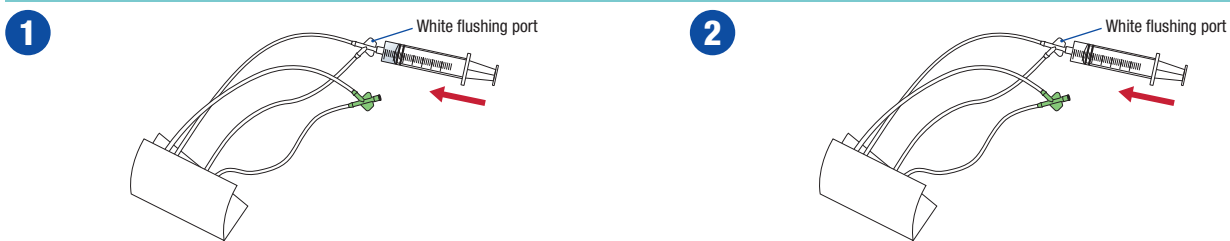
Alcohol flushing process with MAJ-2319



	Flush content	Total flush volume (from each port)	Procedure 
1	Alcohol	30 ml	(Repeat the same procedure from the green flushing port in the all procedure)
2	Air	30 ml	

Cover the white cover and the green cover of MAJ-2319 in sterile lint-free cloths to prevent splashing from the openings of the covers. Fill the syringe with the alcohol, attach it to the white flushing port, and forcefully flush the adapter with 30 ml of the alcohol.

Fill the syringe with air, attach it to the white flushing port, and flush the adapter with 30 ml of air. Confirm that no alcohol exits from both the openings of the white cover and the green cover of the adapter during the flush.

Manufactured by



OLYMPUS MEDICAL SYSTEMS CORP.
2951 Ishikawa-cho, Hachioji-shi, Tokyo 192-8507, Japan Fax: (042)646-2429 Telephone: (042)642-2111

Distributed by

OLYMPUS EUROPA SE & CO. KG
(Premises/ Goods delivery) Wendenstrasse 14-18, 20097 Hamburg, Germany
(Letters) Postfach 10 49 08, 20034 Hamburg, Germany
Fax: (040)23773-4656 Telephone: (040)23773-0

KEYMED (MEDICAL & INDUSTRIAL EQUIPMENT) LTD.
KeyMed House, Stock Road, Southend-on-Sea, Essex SS2 5QH, United Kingdom
Fax: (01702)465677 Telephone: (01702)616333

OLYMPUS MOSCOW LIMITED LIABILITY COMPANY
Elektrozavodskaya str. 27 bld.8, 107023 Moscow, Russia
Fax: (7)495-926-7072 Telephone: (7)495-926-7077

OLYMPUS AMERICA INC.
3500 Corporate Parkway, P.O. Box 610, Center Valley, PA 18034-0610, U.S.A.
Fax: (484)896-7128 Telephone: (484)896-5000

OLYMPUS LATIN AMERICA, INC.
5301 Blue Lagoon Drive, Suite 290 Miami, FL 33126-2097, U.S.A.
Fax: (305)261-4421 Telephone: (305)266-2332

OLYMPUS (BEIJING) SALES & SERVICE CO., LTD.
A8F, Ping An International Financial Center, No. 1-3, Xinyuan South Road,
Chaoyang District, Beijing, 100027 P.R.C.
Fax: (86)10-5976-1299 Telephone: (86)10-5819-9000

OLYMPUS AUSTRALIA PTY LTD
3 Acacia Place, Notting Hill, VIC 3168, Australia
Fax: (03)9543-1350 Telephone: (03)9265-5400

OLYMPUS SINGAPORE PTE LTD
438B Alexandra Road #03-07/12, Alexandra Technopark Bld B, Singapore 119968
Fax: 6834-2438 Telephone: 6834-0010

OLYMPUS KOREA CO., LTD.
2F-3F Majestiar City Tower One, 12, Seocho-daero 38-gil, Seocho-gu, Seoul,
06655, Korea
Fax: (02)6255-3210 Telephone: 1544-3202