

## PolyLoop Ligating Device (HX-400U-30)

### Quick Reference Guide

**CAUTION:** This guide is only a summary of the instructions for use for the HX-400U-30 PolyLoop. Be sure to follow the Olympus EndoTherapy PolyLoop HX-400U-30 instruction manual that was included with your HX-400U-30 purchase.

### Nomenclature

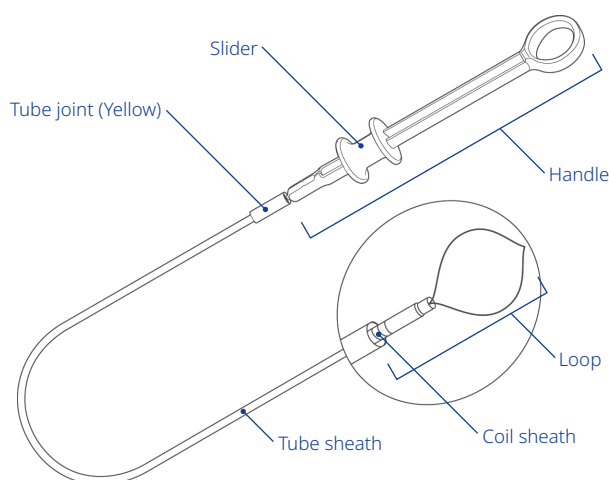

### Preparation

1. Push the tube joint distally to retract the loop into the tube sheath. Carefully insert the instrument into the biopsy valve.

### Operation

2. Pull the tube joint until it touches the handle to extend the loop from the tube sheath.

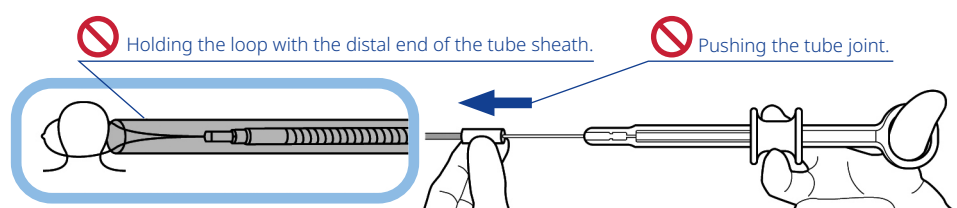
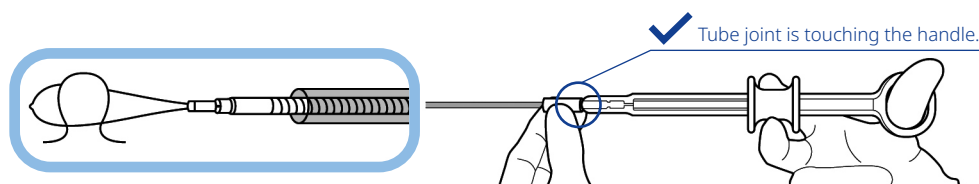
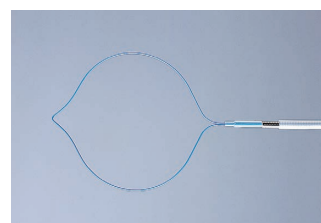
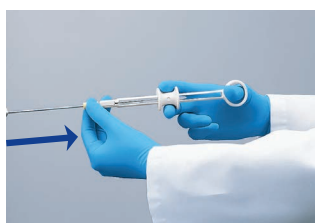

3. Surround the tissue with the open loop. Pull the slider to ligate the target tissue.

**Caution:** Do not apply unnecessary force to the loop when ligating tissue during the procedure.

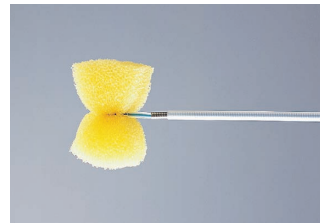
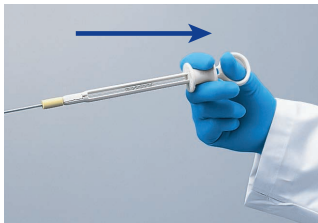

4. Push the slider until it stops to extend the hook from the coil sheath. Detach the loop from the hook.

**Caution:** Do not remove the loop from the hook while the coil sheath is not extended from the tube sheath.

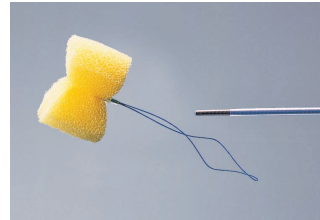
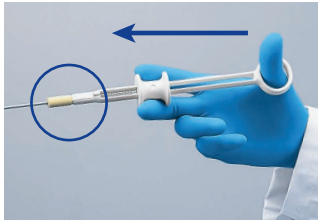

**Caution:** With the proximal end of the tube sheath and handle kept straight against the biopsy valve of the endoscope, push the slider.

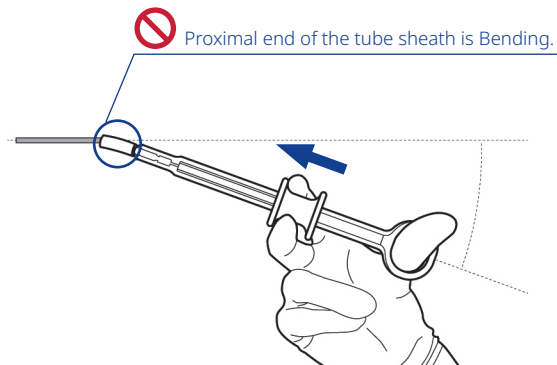
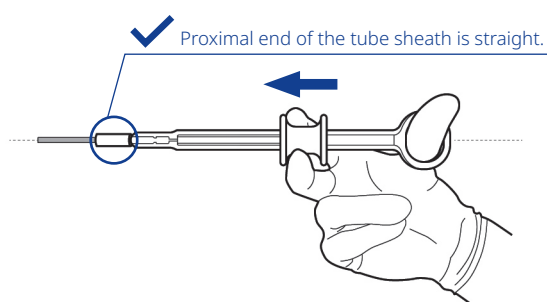
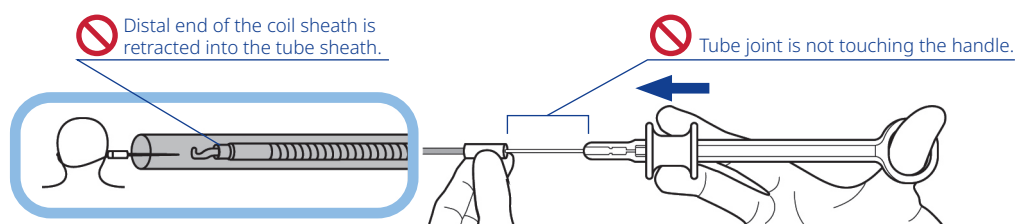
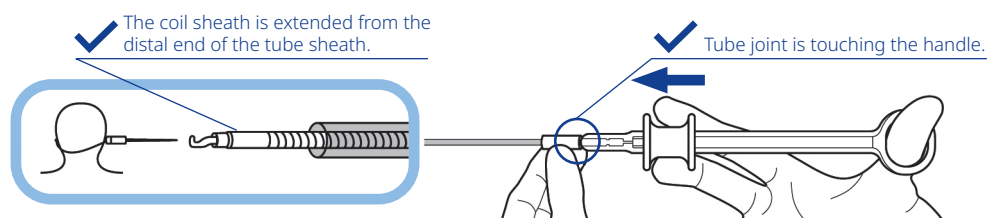

**Note:**

Always have the Olympus loop cutter, pliers and/or wire cutters ready to cut the coil sheath, tube sheath and operation wire in case the loop cannot be detached from the instrument.

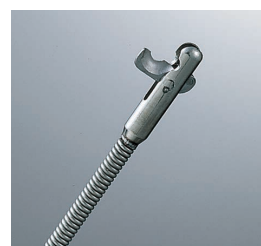

## Emergency Treatment

If the loop cannot be detached from the instrument, follow the procedures described in this section.

1. · Straighten out the portion of the endoscope that extends from the patient.
- Straighten out the portion of the instrument that extends from the biopsy valve.
- Push the slider until it stops to extend the hook from the coil sheath.

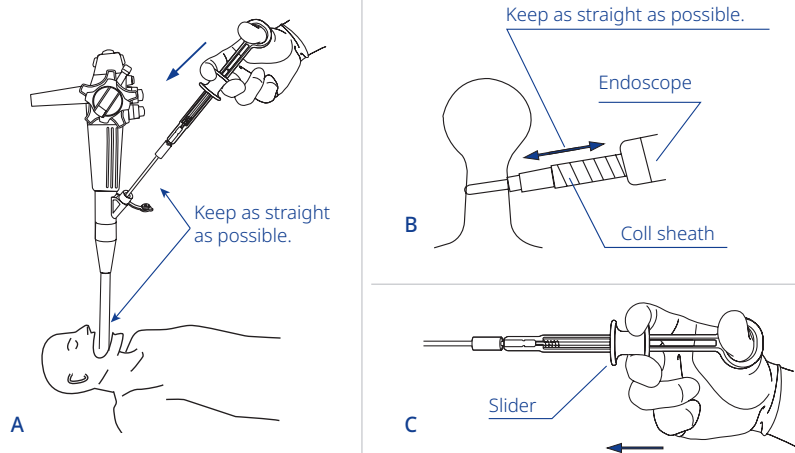

2. · Cut the tube sheath, the coil sheath and operation wire using pliers or wire cutters.
- Withdraw the endoscope.

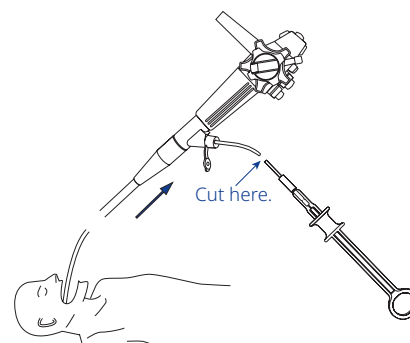

### 3. When the distal end of the coil sheath is not close to the loop stopper.

- Insert the endoscope again along the tube sheath.
- Cut the loop using the Olympus loop cutter.
- Withdraw the tube sheath, coil sheath and operating wire together.

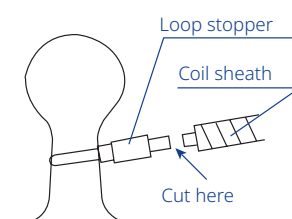

### When the distal end of the coil sheath is close to the loop stopper.

- Leave the loop in place until tissue necrosis occurs and the loop and tissue come free. This may take some time.
- Perform open surgery or other possible treatment.